

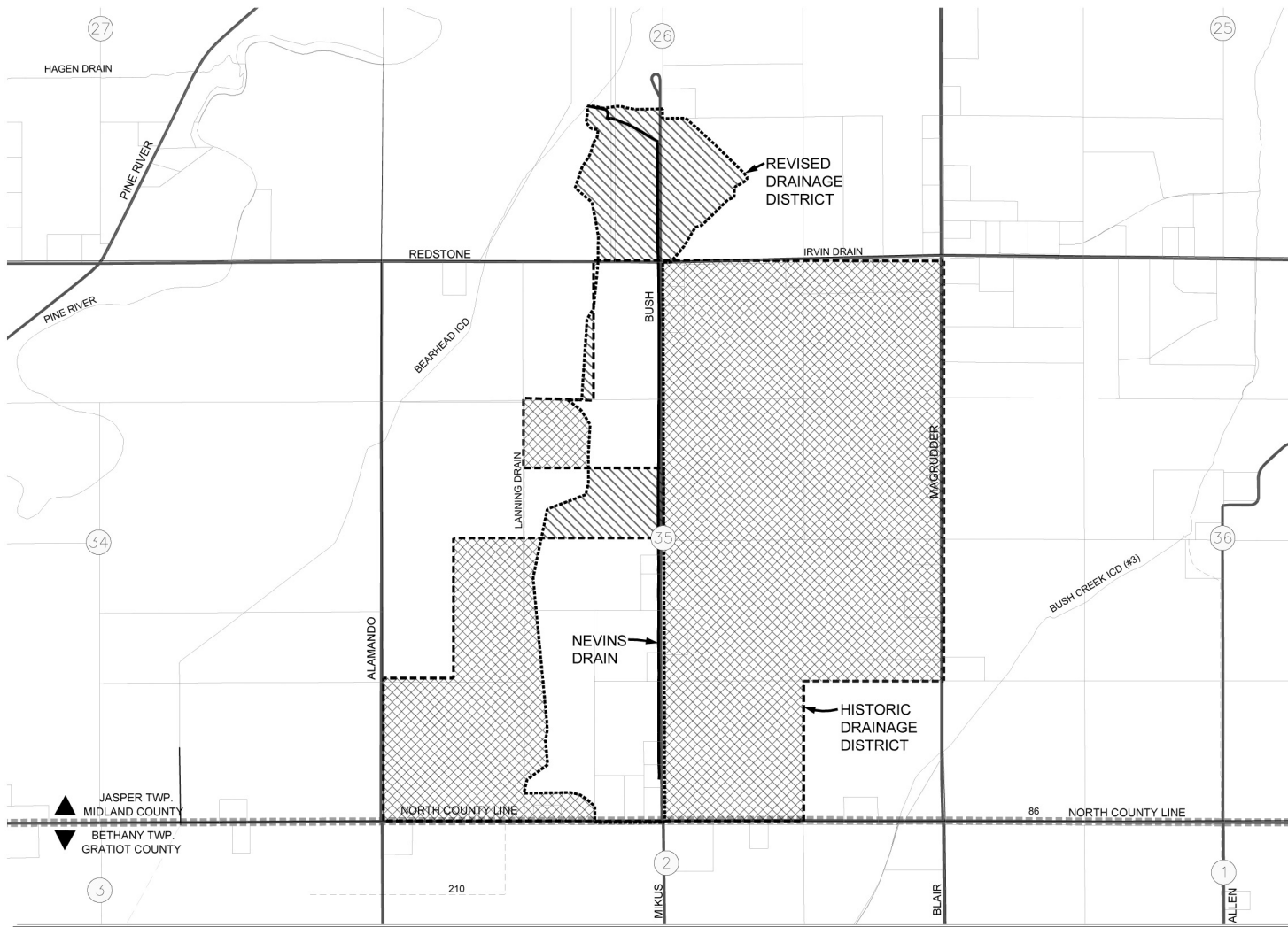

Nevins Drain

Sections 26 & 35
T13N, R02W
Jasper Township, Midland County, Michigan



DRAINAGE DISTRICT INFORMATION:	
HISTORIC DISTRICT:	461.31 ACRES
REVISED DISTRICT:	152.07 ACRES
LANDS ADDED:	52.70 ACRES
LANDS REMOVED:	361.94 ACRES
DRAIN LENGTH:	1.29 MILES

LEGEND	
	LANDS REMOVED
	LANDS ADDED
	DRAIN ALIGNMENT (OPEN CHANNEL)
	DRAIN ALIGNMENT (ENCLOSED)
	HISTORIC DRAINAGE DISTRICT BOUNDARY
	REVISED DRAINAGE DISTRICT BOUNDARY
	CITY/VILLAGE LIMITS
	PARCEL LINES
	ROADS
	SECTION LINES
	TOWNSHIP LINE
	COUNTY LINE
	SECTION NUMBERS

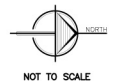

NOT TO SCALE

MAILING MAP

	2121 3 Mile Rd. NW Walker, MI 49544 Ph: 616-501-7888 www.LREMI.com	PROJECT#: 25-033 DRAWN BY: LGG DATE: JULY, 2025 SHEET: 1/1
	ENGINEERS & SURVEYORS	